





násio

LEGENDA	
	CALÇADA EM PAVER A EXECUTAR
	MURETA DE ALVENARIA A EXECUTAR
	CORRIMÃO A EXECUTAR
	GUARDA-CORPO A EXECUTAR

Escola

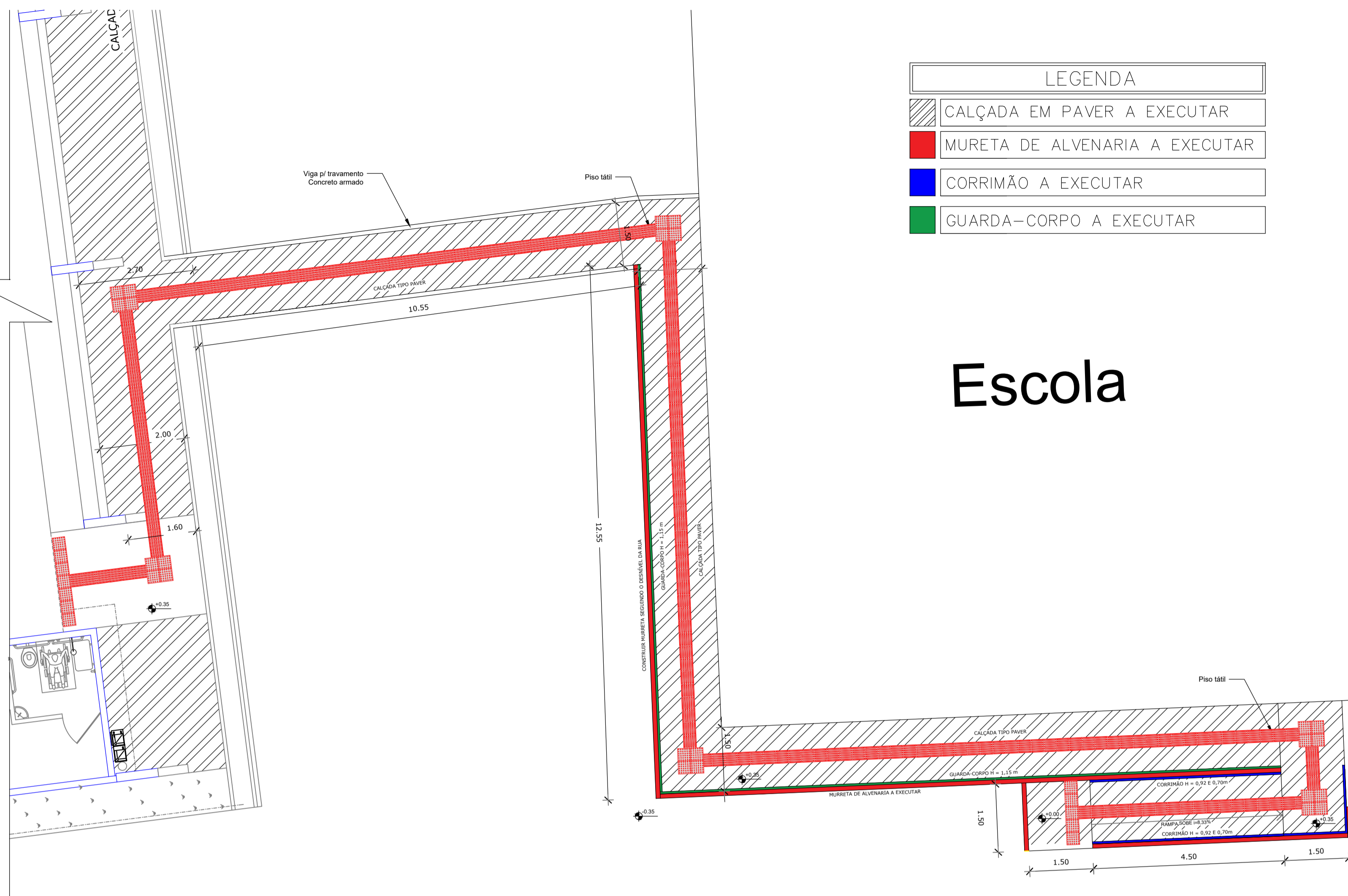

1 PLANTA BAIXA
ESCALA 1/75

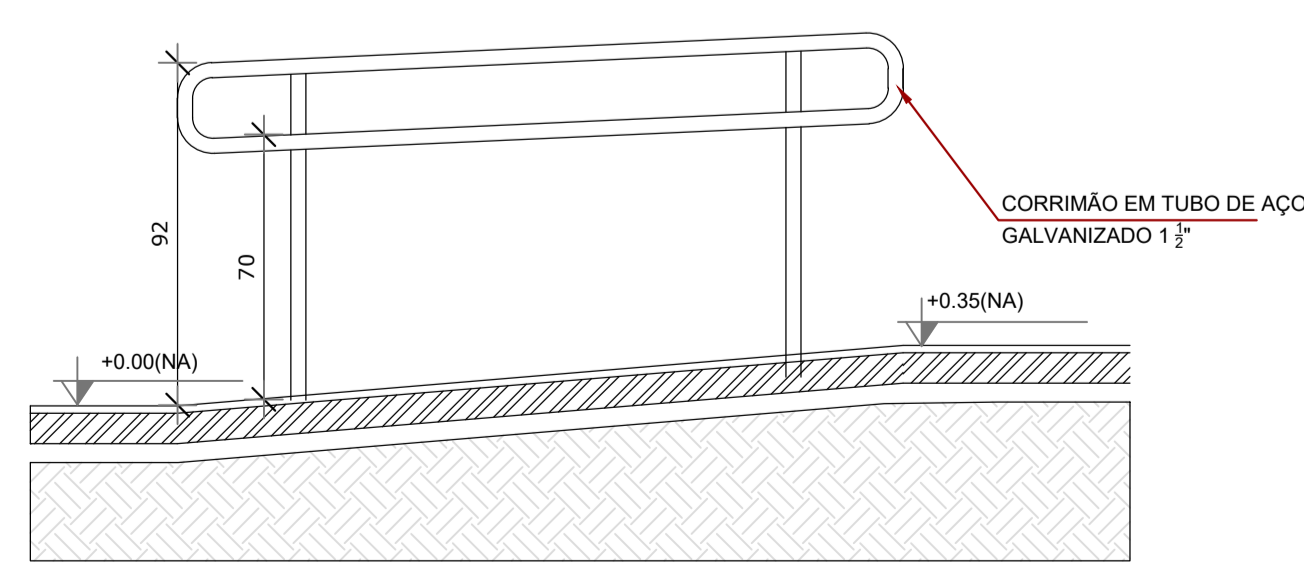
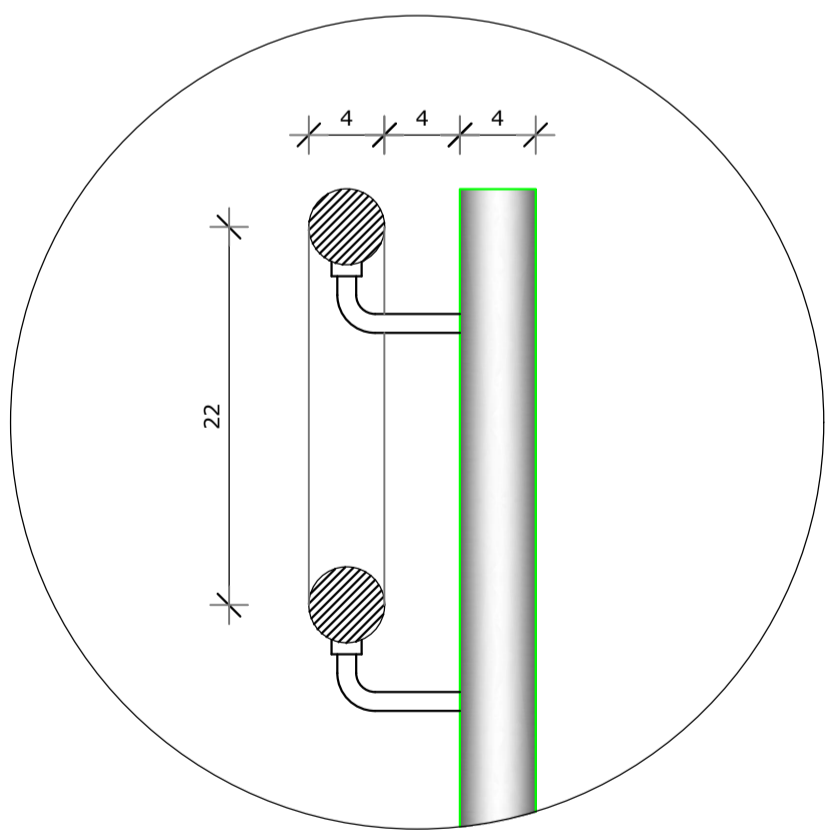

2 DETALHE CORRIMÃO RAMPA
ESCALA 1/20

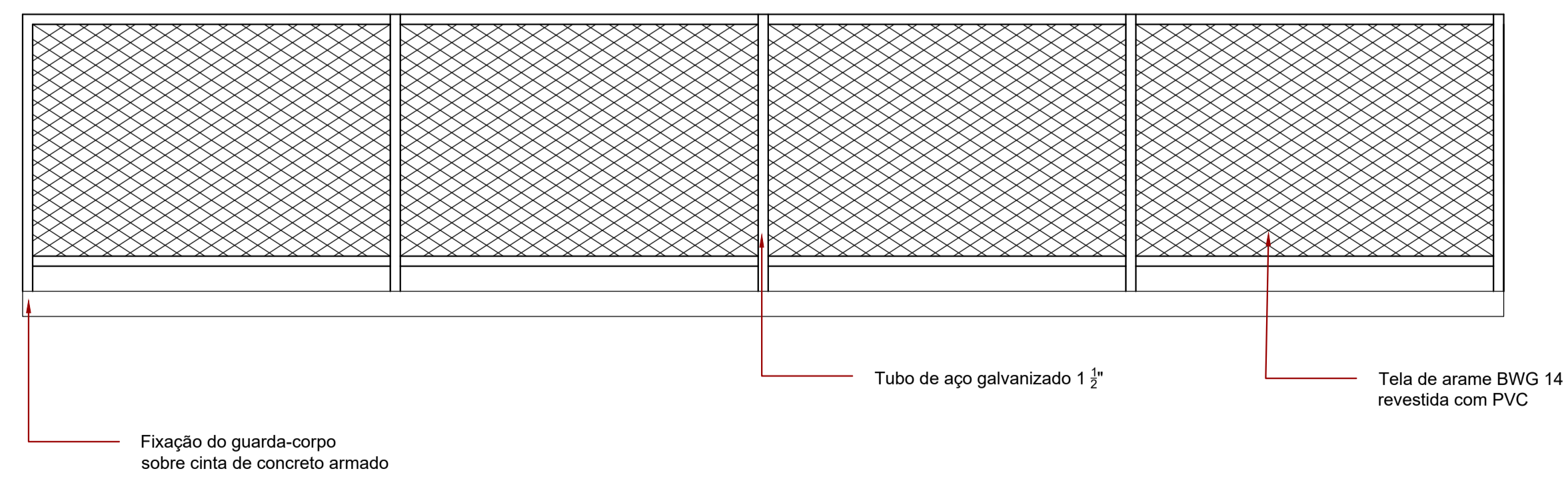

3 DETALHE GUARDA-CORPO
ESCALA 1/20

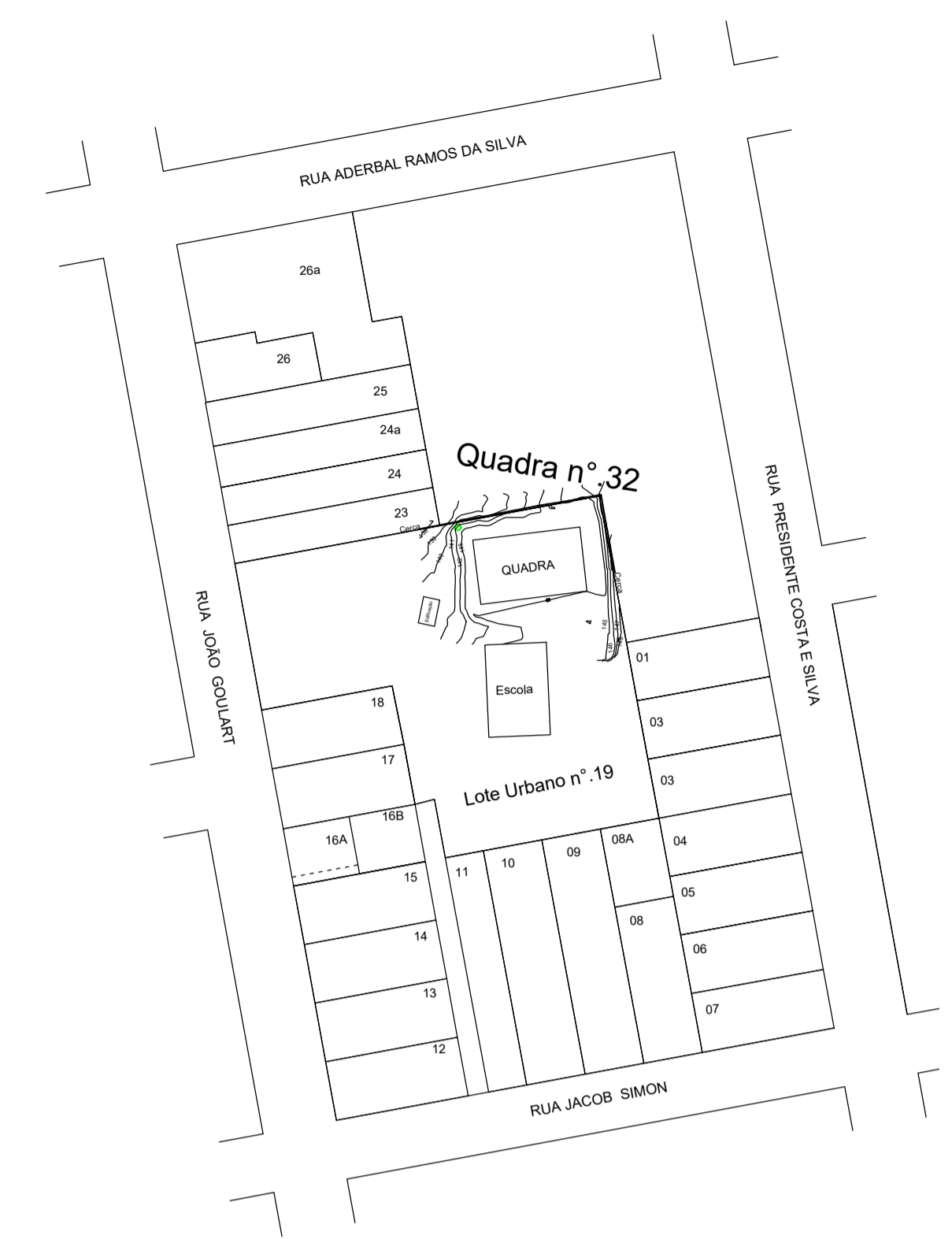

4 PLANTA DE LOCALIZAÇÃO
ESCALA 1/2000

NOTAS

MUNICÍPIO DE QUILOMBO			
OBRA: PAVIMENTAÇÃO DE ACESSO GINÁSIO MADRE PAULINA			
PROPRIETÁRIO	RESPONSÁVEL TÉCNICO	ESCALA: Indicada	DATA: 22/03/2018
MUNICÍPIO DE QUILOMBO		DESENHISTA: Ronaldo	ARQUIVO:
ENDEREÇO DA OBRA: ESCOLA MADRE PAULINA - LOT Nº19 E QUADRA Nº32			PRANCHAS:
CONTEÚDO: PLANTA BAIXA / LOCALIZAÇÃO / DETALHAMENTOS			N. DO PROJETO:
RESPONSÁVEL TÉCNICO PELO PROJETO: Eng. Civil Ronaldo Casagrande / CREA: 14.4569-0 (49) 3346-3242 / Rua Duque de Caxias / Quilombo-SC			